

Case File No. 19-0031
Menards (Waiver)

Blaine Planning Department / 10801 Town Square Dr NE / Blaine, MN 55449 / (763) 785-6180

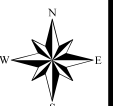

REGISTERED LAND SURVEY NO. _____

City of Blaine
County of Anoka
Section 20, Township 31, Range 23

SURVEYOR'S CERTIFICATE

I hereby certify that in accordance with the provisions of Minnesota Statutes, Section 508.47, I have surveyed the following described property situated in the County of Anoka, State of Minnesota:

That part of the East 664.00 feet of the South 447.11 feet of the Southwest Quarter of the Southeast Quarter of Section 20, Township 31, Range 23, Anoka County, Minnesota lying West of the East 392.00 feet of the Southwest Quarter of the Southeast Quarter.

I hereby certify that this Registered Land Survey was prepared by me or under my direct supervision; that I am a duly Licensed Land Surveyor under the laws of the State of Minnesota and that this Registered Land Survey is a correct representation of said parcel of land.

Dated this _____ day of _____, 20____.

Mark A. Schwanz, Licensed Land Surveyor
Minnesota License No. 45817

State of Minnesota
County of _____

This instrument was acknowledged before me on _____, 20____ by Mark Schwanz, Licensed Land Surveyor.

Notary Public, _____
My Commission Expires _____

CITY COUNCIL, CITY OF BLAINE, MINNESOTA

We do hereby certify that on the _____ day of _____, 20____, the City Council of the City of Blaine has approved this Registered Land Survey.

Mayor _____ Clerk _____

COUNTY SURVEYOR, ANOKA COUNTY, MINNESOTA

Pursuant to Minnesota Statutes, Section 389.09 Subd. 1, this Registered Land Survey has been reviewed and approved this _____ day of _____, 20____.

By: _____
Charles F. Glitzen
Anoka County Surveyor

COUNTY AUDITOR/TREASURER

Pursuant to Minnesota Statutes, Chapter 508.47, Subd. 4, taxes payable for the year 20____ on the land hereinbefore described have been paid. Also, pursuant to Minnesota Statutes, Section 272.12, there are no delinquent taxes and transfer entered this _____ day of _____, 20____.

Property Tax Administrator
By _____, Deputy

COUNTY RECORDER/REGISTRAR OF TITLES
County of Anoka, State of Minnesota

I hereby certify that this REGISTERED LAND SURVEY NO. _____ was filed in the office of the County Recorder/Registrar of Titles for public record on this _____ day of _____, 20____, at _____ o'clock _____ M. and was duly recorded as Document Number _____.

County Recorder/Registrar of Titles
By _____, Deputy



BEARING NOTE:
The orientation of this bearing system is based on the plat of National Market Center.

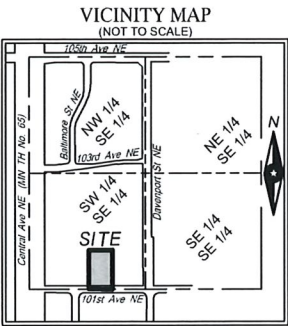

SE 1/4 SEC. 20, TWP. 31, RGE. 23
Anoka County, Minnesota

LEGEND

● Monument Found

ISG