

Case File No. 18-0022
Church of St. Timothy

Blaine Planning Department / 10801 Town Square Dr NE / Blaine, MN 55449 / (763) 785-6180

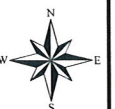

2008 Aerial



04/17/2008

© 2008 Pictometry

2011 Aerial



© 2011 Pictometry

05/03/2011



ING: 15T VK 799314 977056

4-4717



Fully refundable pending permit

MINNESOTA

Economy Garages USA, Inc.
D/B/A Economy Garages
License Number BC002259
5389 Miller Trunk Highway
Duluth, MN 55811-1207
218-729-5106
1-800-582-3600

Name: St. Timothy's Catholic Church
Mailing Address: 707 89th Av NW
City: Blaine State: MN Zip:
Site Address: 707 89th Av NW
City: Blaine State: MN Zip:
Property Owner(s): St. Timothy's Catholic Church

Job Number:
Date: 3/2/2018
Email:
Primary Phone:
Secondary Phone:
Building Site County: Anoka

(Note if the property is leased, subject to contract for deed or located on tribal land)

1. Building Size & Style: 30' x 30' Size [] Gable [x] Reverse Gable [] Other

2. Removals: [] N/A
Stumps (Number) [] By Economy [] By Purchaser [] N/A
Garage (Size) [] By Economy [] By Purchaser [] N/A
Concrete (Size) [] By Economy [] By Purchaser [] N/A
Other (Supplement) [] By Economy [] By Purchaser [] N/A

3. Site Preparation: Concrete Preparation [] By Economy [x] By Purchaser [] N/A
Class #5 Gravel (Supplement) [] By Economy [] By Purchaser [x] N/A
Drain Tile [] By Economy [] By Purchaser [] N/A
Other (Supplement) [] By Economy [] By Purchaser [] N/A

4. Concrete: (Standard concrete slab includes 5" slab, 4,000 psi concrete, 6x6-10 gauge mesh, 1/2" anchor bolts, #4 rebar)
30' x 30' Slab [x] By Economy [] By Purchaser [] N/A [] In-Floor Heat/Plumbing [] By Purchaser [x] N/A
Apron [] By Economy [] By Purchaser [x] N/A [] Nylon Fibers [] By Economy [x] N/A
Driveway [] By Economy [] By Purchaser [x] N/A [] Slope Around Owner [] By Economy [x] N/A
Sidewalk [] By Economy [] By Purchaser [x] N/A Installed Drain [] By Economy [] By Purchaser [x] N/A
Rebar Grid [] By Economy [] By Purchaser [x] N/A
12" x 10" Grade Beam/ Footing (inches) [x] By Economy [] By Purchaser [] N/A
" Vertical Perimeter Foam [] By Economy [] By Purchaser [x] N/A
" Horizontal Perimeter Foam [] By Economy [] By Purchaser [x] N/A

5. Blocks: [] By Economy [] By Purchaser [x] N/A
Lineal Feet _____ Number of Courses _____
Block Size [] 6" [] 8" [] 12"
[] Water Provided By Purchaser
Other _____
Core Fill [] By Economy [] By Purchaser [] N/A
Back Plaster [] By Economy [] By Purchaser [] N/A
Foundation Coating [] By Economy [] By Purchaser [] N/A
Other (Supplement) [] By Economy [] By Purchaser [] N/A

6. Wall Studs & Plates: [x] 2 x 4 [] 2 x 6 9' 0" Ceiling Height

7. Engineered Trusses: 4/12 Pitch 3 1/2" / 16" Raised Heel [x] Common [] Room in Attic [] Other (Supplement)
[] Storage [] Scissor (Trusses rated at 42 lb live/62 lb total load. Hurricane fasteners are standard.)

8. Overhangs: 24" Eave Overhang 12" Gable Overhang [] Boxed [] Flat Boxed In [x] Flat Boxed Out

9. Roofing: CertainTeed Brand Landmark Architectural Style Weathered Wood Color
Musket Roof Edge Color [] Other (Supplement) (Ice & Water Shield, 15/32 OSB and 15 lb ASTM felt is standard.)

10. Ventilation: [x] Shingle Over Ridge Vent _____ Vented Soffit Strip Color [] Other (Supplement) [] N/A

11. Soffit & Fascia: [x] Pine Fascia [] Cedar Fascia Aluminum Soffit & Fascia Musket Color Kelley Brand
[] 3/8" Wood Soffit [] Other (Supplement)

12. Garage Door(s): [] N/A
Wayne Dalton Model & Panel Brown Color 1 Quantity 18 Width 8 Height Musket Jamb Bend Color
7605 Colonial Model & Panel _____ Color _____ Quantity _____ Width _____ Height _____ Jamb Bend Color
[] 45° Corners [] Frame for Purchaser's Garage Door (Supplement) (Engineered wood headers used on all garage doors.)

13. Operator(s): [] N/A 1 Quantity 3/4 hp equiv Power 1 Additional Remotes [] Other (Supplement)

14. Service Door(s): 2 Quantity Bahama Brown Prefinished Door Color [x] Deadbolt
3 x 6'8" Bahama Brown Clad Jamb Color [] Outswing
[] Primed Service Door [] Plain Lite [] Other (Supplement)

15. Window(s): _____ Quantity _____ Size _____ Brand & Model _____ Color
_____ Quantity _____ Size _____ Brand & Model _____ Color
[x] N/A _____ Quantity _____ Size _____ Brand & Model _____ Color

16. Wall Sheathing & Siding: [] T1-11 8" o.c. Siding [x] OSB [] Other (Supplement) [x] Housewrap 2 J-Blocks
CertainTeed Monogram Vinyl Siding Type DMCB Reveal
Double 4" Clap Board Profile (Size & Style) Light Maple Color

17. Project Information: Permit [] By Economy [x] By Purchaser [] N/A Power on Site [x] Yes [] No
Clean-up [x] By Economy [] By Purchaser (Existing power must be within 100' at the time contract is signed to mark yes.)

18. Additional features are described on Contract Supplement: _____ Number of pages [x] N/A

5389 Miller Trunk Hwy
Duluth, MN 55811-1207

economygarages.com

MN License #BC002259 • WI License #107855

Name St Timothy's Catholic Church Date 3/7/2018

Job Address 707 89th Av. NE Size 30' x 30'

City, St, Zip Blaine Mn 55434

Permit Area Blaine Mn Primary Phone: _____

Sales Representative Mike Cotten Secondary Phone: _____

Top of prepared site _____	<input checked="" type="checkbox"/> Purchaser
Top of floor _____	<input checked="" type="checkbox"/> Purchaser
Fixed point ⊗ _____	<input checked="" type="checkbox"/> Purchaser
Location _____	
<input type="checkbox"/> Remove extra material	<input type="checkbox"/> Leave extra material _____

<input checked="" type="checkbox"/> Square with <u>Exist garage</u>	<input type="checkbox"/> N/A
<input checked="" type="checkbox"/> Distance to property lines and structures marked	<input type="checkbox"/> N/A
<input type="checkbox"/> Conduit	<input type="checkbox"/> Purchaser
<input type="checkbox"/> Drain	<input type="checkbox"/> Purchaser
<input checked="" type="checkbox"/> 2x4 wall	<input type="checkbox"/> Concrete encased electrode
<input type="checkbox"/> 2x6 wall	

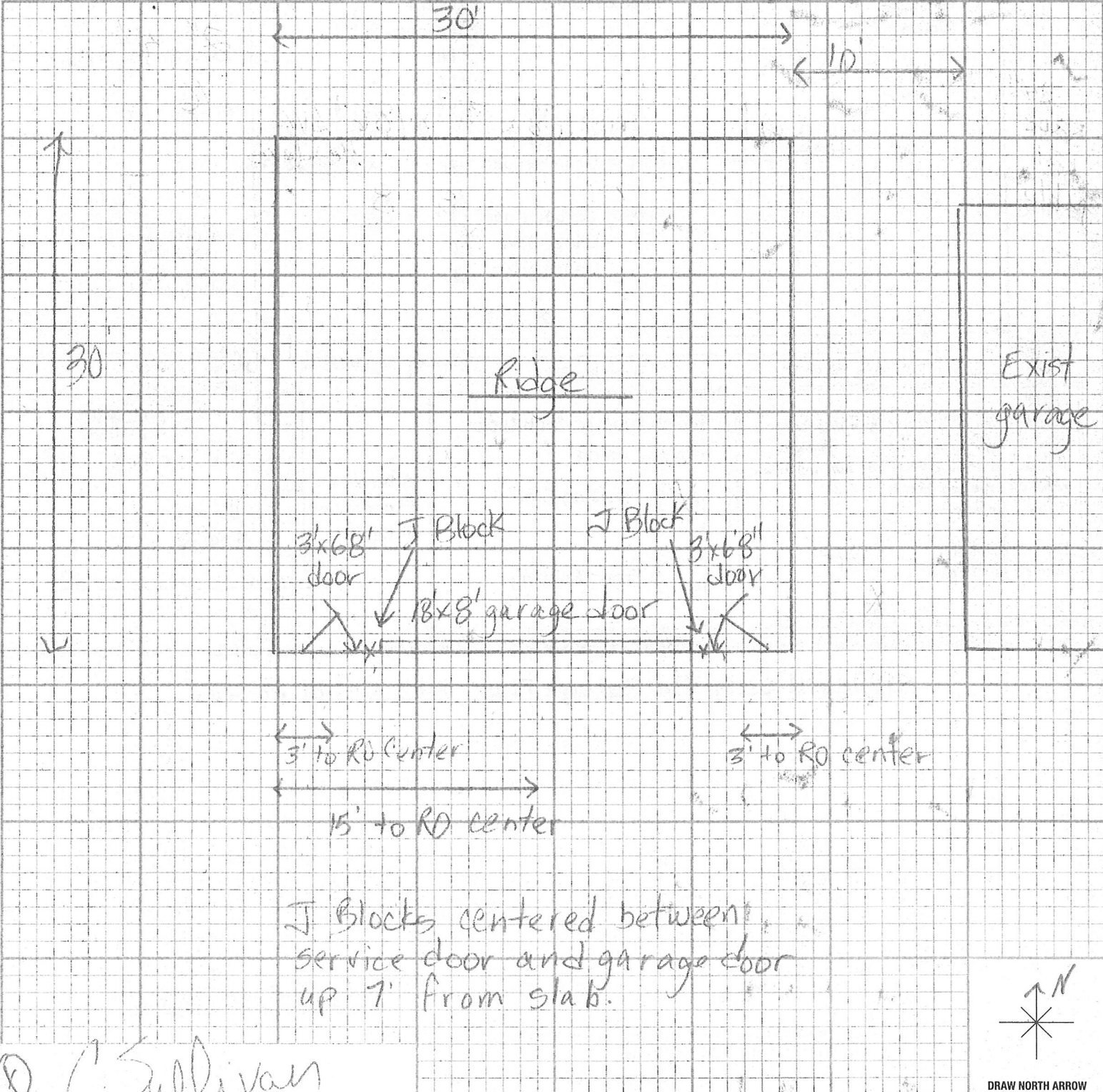

(S) Sullivan
Purchaser's Signature

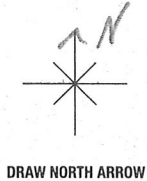

GARAGES/Detached Accessory Buildings

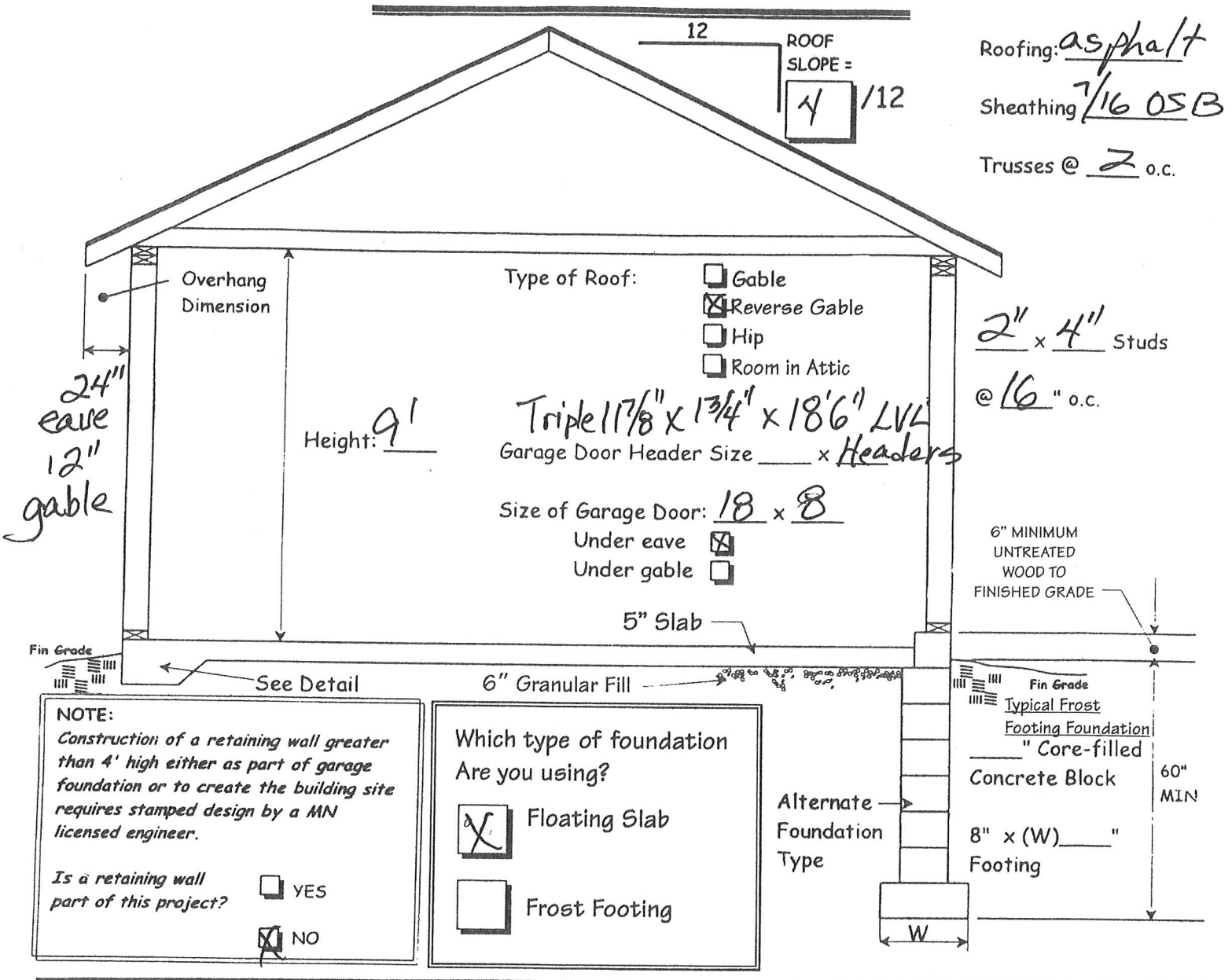

Standard Concrete Garage Floor Slab Detail No Scale

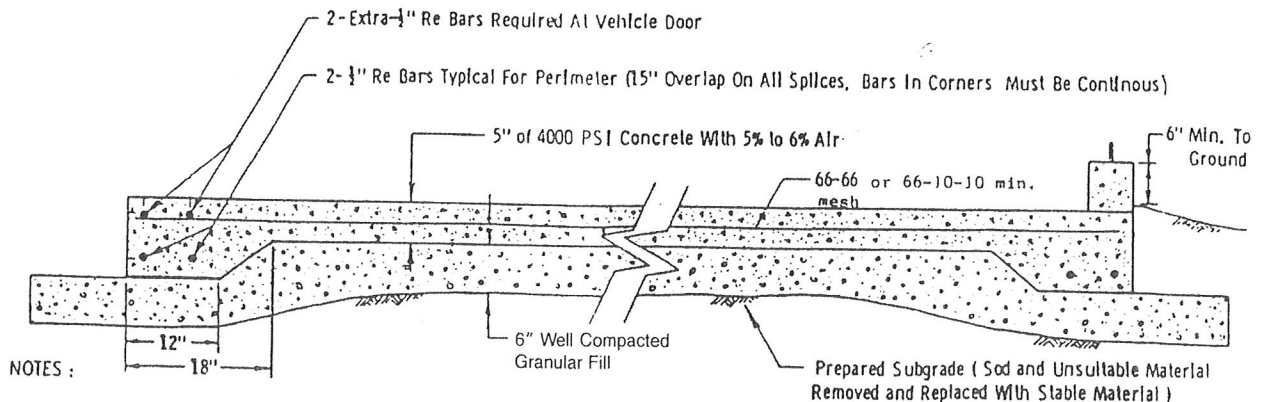

1. Provisions To Anchor Garage To Slab - Use 1/2 Dia. Steel Bolts at Least 7" Into The Concrete And Spaced Not More Than 6' Apart Sec. 2907 (e)
2. Foundation Plates On A Concrete Slab Shall Be Treated Wood
3. Thickness of Grade Beam Varies by Permit Area







Narrative

Lukacs, Natasha

From: Joe Whalen
Sent: Tuesday, March 20, 2018 12:15 PM
To: Lukacs, Natasha
Subject: St Tim's Info and Plx

Hello Natasha,

Attached are photos of the site as it appears today. I tried to size these a bit smaller but am not sure it worked. If you have trouble opening them let me know and I can forward hard copies through the mail.

The building use will be storage of church goods and materials. The Knights of Columbus affiliated with St Tim's will store a stage/dance floor, accessing that material 4-5 times per year for various church and civic events that they sponsor. The parish will store materials such as 8' long tables we use for parish events, the large tents we use for the annual carnival, some land/lawn care equipment our maintenance staff uses, and also materials from the church for worship environment, such as large banners for the worship space, a number of artificial Christmas trees, youth group choir risers and materials for Stations of the Cross.... Primarily large, bulky items that we are either storing off-site at storage facilities that charge too much, or items we will move from existing on-site locations that we adapted after demolishing the old clergy residence last year. Much of this material was stored in the underground garage(s) of the old clergy house facing 89th, so when that came down last year, we needed to find a permanent solution for the materials that we kept in storage there. This garage is the answer to that question.

So I hope that will help. If you need anything else please let me know,

Thanks very much,

Fr. Joe Whalen
Pastor
Church of St. Timothy
707-89th Ave NE
Blaine, Mn. 55434

This message is confidential. It may also be privileged or otherwise protected by work product immunity or other legal rules. If you have received it by mistake, please let us know by e-mail reply and delete it from your system; you may not copy this message or disclose its contents to anyone. Please send us by fax any message containing deadlines as incoming e-mails are not screened for response deadlines. The integrity and security of this message cannot be guaranteed on the Internet.