

CONSTRUCTION PLANS FOR: IMPROVEMENT PROJECT NO. 14-02 2014 SEALCOAT, VARIOUS CITY STREETS

LEGEND

PROJECT LOCATION MAP

EXISTING

	STORM SEWER & MANHOLE
	SANITARY SEWER & MANHOLE
	WATERMAIN, HYDRANT, VALVE & MANHOLE
	CULVERT
	BULKHEAD
	UNDERGROUND TELEPHONE LINE
	TELEPHONE MANHOLE
	UNDERGROUND ELECTRIC LINE
	ELECTRIC MANHOLE
	GAS MAIN & VALVE
	STREET LIGHT
	MAILBOX
	TRAFFIC SIGN
	STREET SIGN
	POWER POLE W/ GUY WIRE
	DECIDUOUS TREE
	CONIFEROUS TREE
	BUSH - SHRUB
	HEDGE
	WOODED AREA
	FENCE
	GUARD RAIL
	DITCH
	TRAFFIC SIGNAL POLE
	HANDHOLE
	CONCRETE CURB & GUTTER
	BITUMINOUS CURB
	CONCRETE PAVEMENT
	BUILDING
	SECTION LINE
	QUARTER LINE
	SIXTEENTH LINE
	RIGHT OF WAY LINE

PROPOSED

	CONSTRUCTION LIMITS
	CONSTRUCTION CENTERLINE
	RIGHT OF WAY LINE
	STORM SEWER & MANHOLE
	SANITARY SEWER & MANHOLE
	WATERMAIN, HYDRANT, VALVE & MANHOLE
	CULVERT
	CATCH BASIN
	BULKHEAD
	CONCRETE CURB & GUTTER

NOTES:

1. THE EXACT LOCATION OF UNDERGROUND UTILITIES SUCH AS GAS, TELEPHONE, FIBEROPTIC, ELECTRIC, CABLE TV AND PIPELINES ARE UNKNOWN. THE CONTRACTOR SHALL CONTACT GOPHER STATE ONE CALL BEFORE COMMENCING AND CONSTRUCTION OR EXCAVATION. GOPHER STATE ONE CALL SYSTEM.....1-800-252-1166
2. THE SUBSURFACE UTILITY INFORMATION IN THIS PLAN IS UTILITY QUALITY LEVEL D. THIS QUALITY LEVEL WAS DETERMINED ACCORDING TO THE GUIDELINES OF C/ASCE 38-02, ENTITLED "STANDARD GUIDELINES FOR THE COLLECTION AND DEPICTION OF EXISTING SUBSURFACE UTILITY DATA."
3. ALL TRAFFIC CONTROL DEVICES AND SIGNING SHALL CONFORM TO THE MMUTCD, INCLUDING "FIELD MANUAL FOR TEMPORARY TRAFFIC CONTROL ZONE LAYOUTS" - CURRENT EDITION.
4. THE 2014 EDITION OF THE MINNESOTA DEPARTMENT OF TRANSPORTATION STANDARD SPECIFICATIONS FOR CONSTRUCTION AND THE 2014 EDITION OF THE MATERIALS LAB SUPPLEMENTAL SPECIFICATIONS FOR CONSTRUCTION SHALL GOVERN EXCEPT AS MODIFIED BY THE SPECIFICATIONS FOR THIS PROJECT.

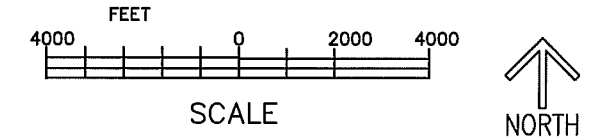
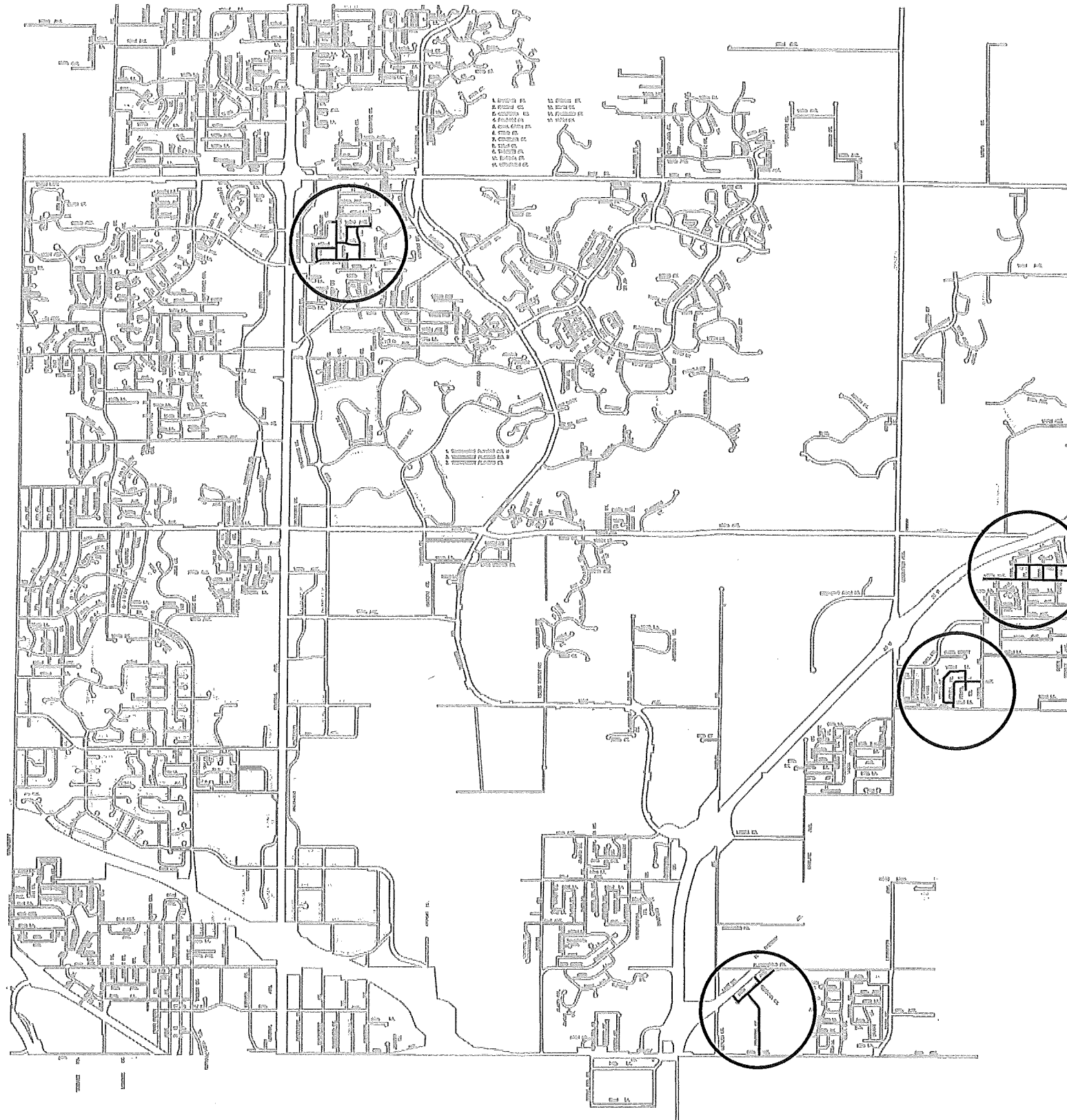

ENGINEERING DEPARTMENT
10801 Town Square Drive, Blaine, Minnesota 55434
Phone (763) 785-6172

I hereby certify that this plan, specification or report was prepared by me or under my direct supervision and that I am a duly Licensed Professional Engineer under the laws of the State of Minnesota.

Daniel S. Schluender
Daniel S. Schluender
Date: 03/03/14, Minnesota Licensed No. 26771

INDEX TO PLANS

SHEET NO.	DESCRIPTION
1	TITLE
2-3	SEAL COAT