

Zoning & Location Map

Case File No. 11-0007



City of Blaine Planning Department / 10801 Town Square Dr NE / Blaine, MN 55449 / (763) 785-6180



PRELIMINARY PLAT OF WOODLAND VILLAGE BLAINE, MINNESOTA

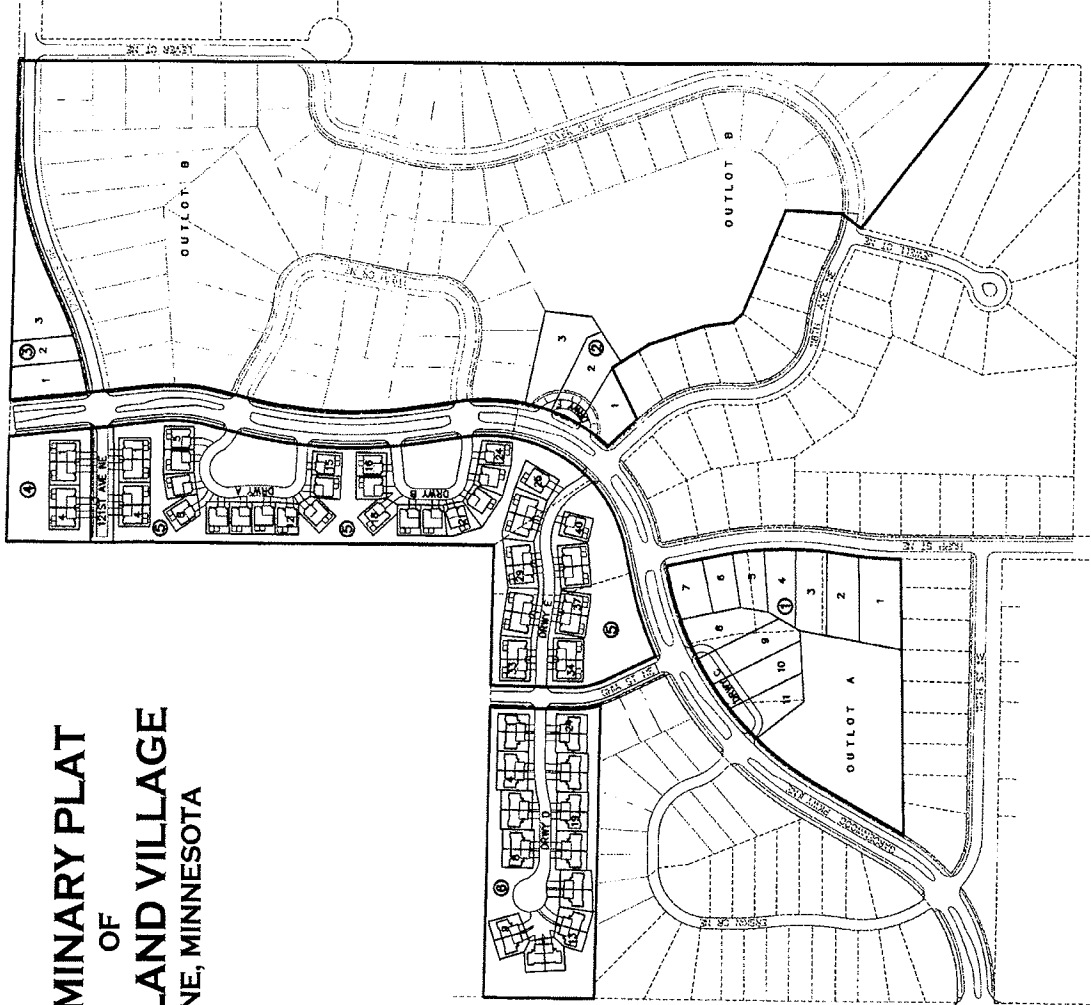

VICINITY MAP

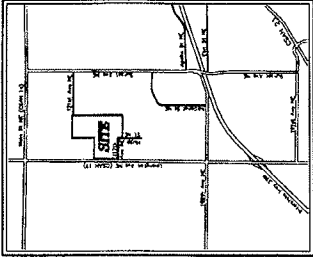

SHEET INDEX

1. COVER
2. EXISTING CONDITIONS
3. UTILITIES
4. PRELIMINARY PLAT
5. PRELIMINARY PLAT
6. PRELIMINARY SITE & UTILITY PLAN
7. PRELIMINARY SITE & UTILITY PLAN
8. PRELIMINARY GRADING & EROSION CONTROL PLAN
9. PRELIMINARY GRADING & EROSION CONTROL PLAN
10. PRELIMINARY GRADING & EROSION CONTROL PLAN
11. DETAILS
12. DETAILS

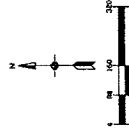

BENCHMARKS

1.	10' WIDE CONCRETE	10' WIDE CONCRETE
2.	10' WIDE CONCRETE	10' WIDE CONCRETE
3.	10' WIDE CONCRETE	10' WIDE CONCRETE
4.	10' WIDE CONCRETE	10' WIDE CONCRETE
5.	10' WIDE CONCRETE	10' WIDE CONCRETE
6.	10' WIDE CONCRETE	10' WIDE CONCRETE
7.	10' WIDE CONCRETE	10' WIDE CONCRETE
8.	10' WIDE CONCRETE	10' WIDE CONCRETE
9.	10' WIDE CONCRETE	10' WIDE CONCRETE
10.	10' WIDE CONCRETE	10' WIDE CONCRETE
11.	10' WIDE CONCRETE	10' WIDE CONCRETE
12.	10' WIDE CONCRETE	10' WIDE CONCRETE



These drawings were prepared by the undersigned in accordance with the provisions of the Minnesota Statutes, Chapter 471, Section 03.01, and the rules of the Board of Professional Engineers, Architects, and Landscape Architects, State of Minnesota.

<p>Carlson PROFESSIONAL SERVICES</p>	<p>19522 Van Buren Street NE Ham Lake, MN 55304</p>	<p>WOODLAND VILLAGE Blaine, Minnesota</p>	<p>1 of 12</p>
	<p>WOODLAND DEVELOPMENT CORP.</p>	<p>COVER</p>	

Carlson 2008 - 2009 Annual Report - Engineering Services - 2008-2009 - 10/20/09 - 10/20/09 - 10/20/09