

**Case File No.13-0064**

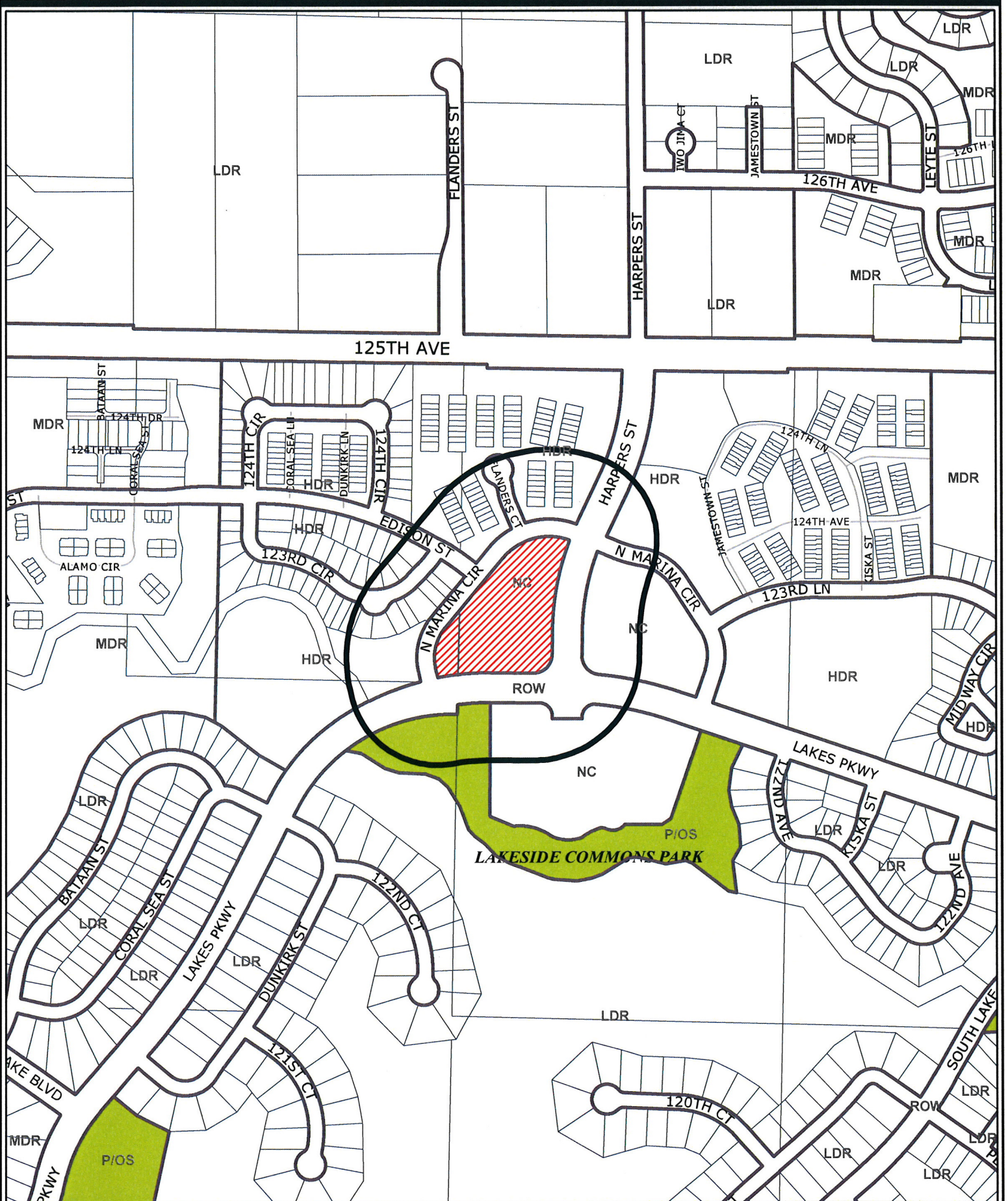

Blaine Planning Department / 10801 Town Square Dr NE / Blaine, MN 55449 / (763) 785-6180





**Case File No. 13-0064 - Land Use Map**

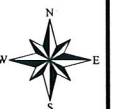

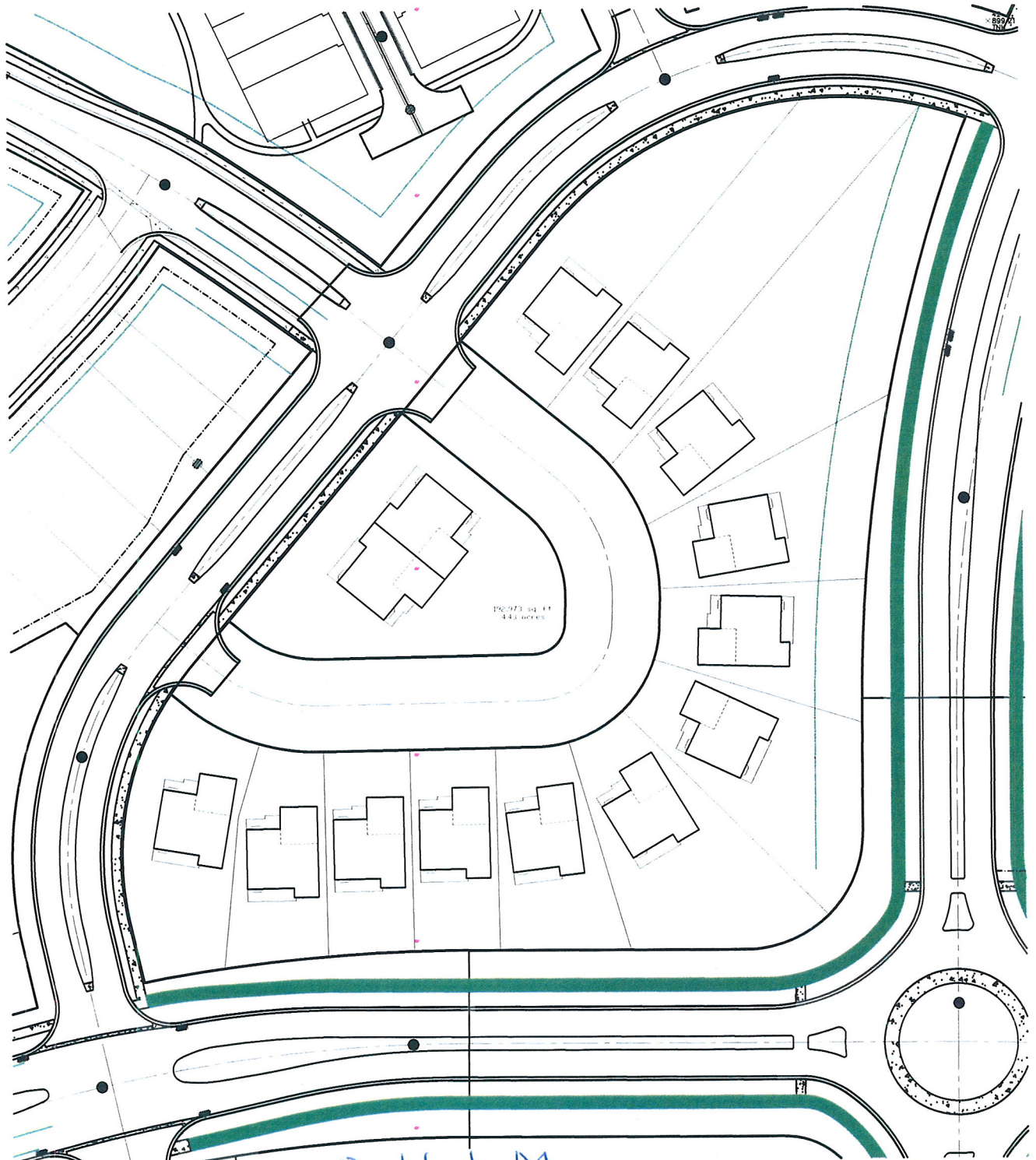

Outlot M  
The Lakes of Radisson  
Village Bank  
9298 Central Ave. NE  
Blaine, MN 55434