

INFORMATION  
MINIMUM FALL ZONE  
SURFACED WITH  
RESILIENT MATERIAL  
AREA

5603 SQ.FT.

PERIMETER  
670 FT.

STRUCTURE SIZE  
101' 3" x 71' 6"

STRUCTURE IS DESIGNED  
FOR CHILDREN AGES:

- 6-23 MONTH OLDS
- 2-5 YEAR OLDS
- 5-12 YEAR OLDS
- 13 + YEAR OLDS



Registered  
to ISO 9001

Registered  
to ISO 14001



To verify product certification,  
visit [www.ipema.org](http://www.ipema.org)

The play components identified  
in this plan are IPEMA  
certified. The use and layout of  
these components conform to the  
requirements of ASTM F1487.  
To verify product certification,  
visit [www.ipema.org](http://www.ipema.org)

The space requirements shown  
here are to ASTM standards.  
Requirements for other standards  
may be different.

The use and layout of play  
components identified in this plan  
conform to the CPSC guidelines.  
U.S. CPSC recommends the  
separation of age groups in  
playground layouts.

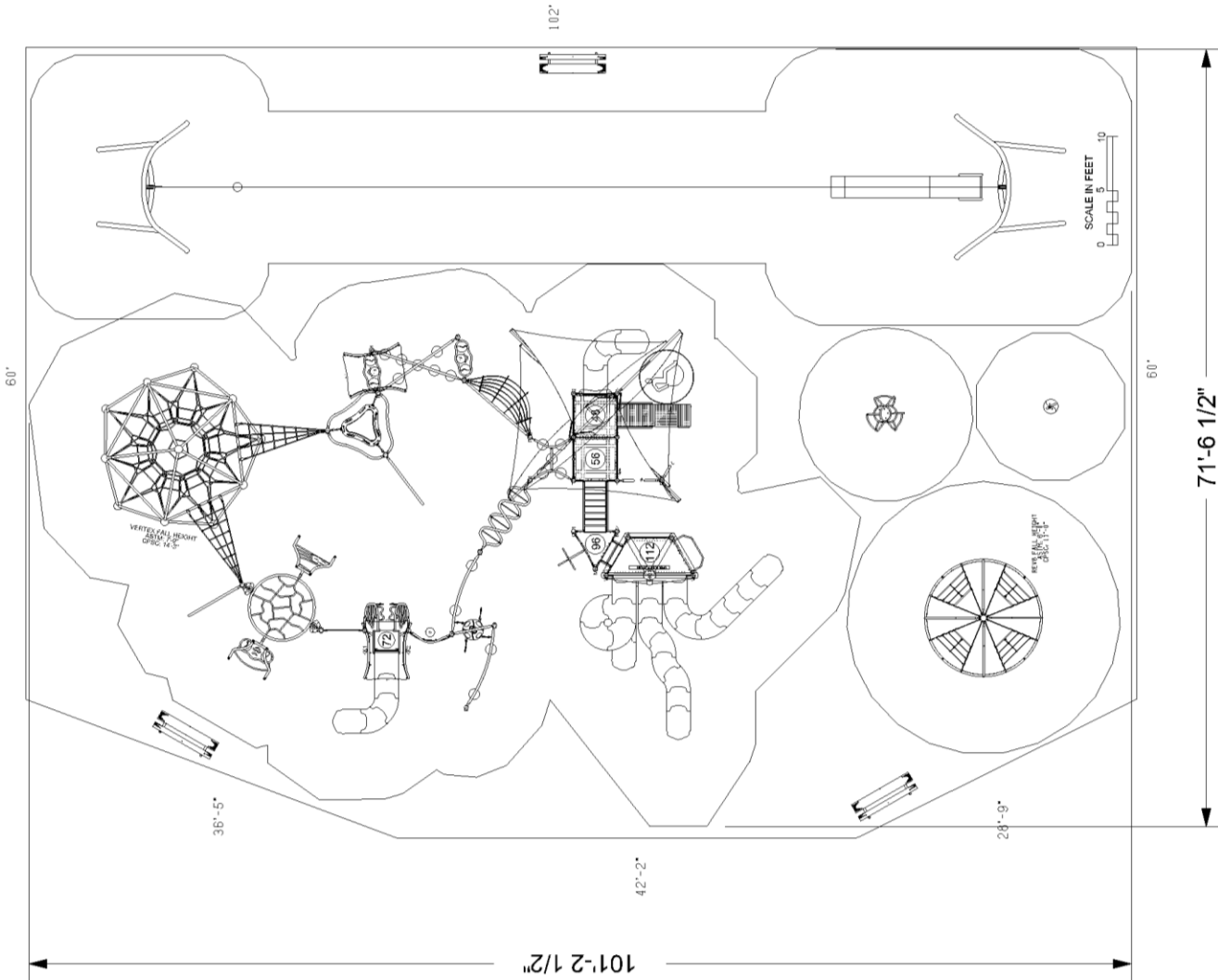

**WARNING!**

ACCESSIBLE SAFETY SURFACING MATERIAL IS REQUIRED BENEATH  
AND AROUND THIS EQUIPMENT.  
FOR SLIDE FALL ZONE SURFACING AREA SEE CPSC's Handbook for  
Public Playground Safety.  
PLATFORM HEIGHTS ARE IN INCHES ABOVE RESILIENT MATERIAL.

**ADA ACCESSIBILITY GUIDELINE (ADAAG CONFORMANCE)**

NUMBER OF PLAY EVENTS:	29
NUMBER OF ELEVATED PLAY EVENTS:	8
NUMBER OF ELEVATED PLAY EVENTS ACCESSIBLE BY RAMP:	PROVIDED: 0
NUMBER OF ELEVATED PLAY EVENTS ACCESSIBLE BY TRANSFER SYSTEM:	PROVIDED: 5
NUMBER OF ELEVATED PLAY EVENTS ACCESSIBLE BY RAMP OR TRANSFER SYSTEM:	PROVIDED: 4
NUMBER OF GROUND LEVEL PLAY EVENTS:	PROVIDED: 21
NUMBER OF TYPES OF GROUND LEVEL PLAY EVENTS:	PROVIDED: 6
RECD: 0	RECD: 0
RECD: 5	RECD: 4
RECD: 21	RECD: 3
RECD: 6	RECD: 3



SERIES: Basics, Intensity, Nucleus

SITE PLAN

DRAWN BY: Kari Champeau

Lexington Athletic Complex

4286 121st Ave. NE

Blaine, MN 55449

St. Croix Recreation Company, Inc.

100-99184-1

March 13, 2017

ITEM	COMP.	DESCRIPTION
1	270-0001	OFFSET ENCLOSURE
2	270-0050	8" CLOSURE PLATE
3	270-0129	TRIANGLE PLATFORM
4	270-0130	SQUARE PLATFORM
5	270-0148	BALCONY
6	270-0236	VIPER SLIDE HALF HEX PLATFORM
7	270-0287	SLIDE PLATFORM
8	370-0008	WILD WEB ROPE CLIMBER
9	370-0026	CLIMBER LADDER ROPE CLIMBER
10	370-0027	LAUNCH PAD
11	370-0466	16" TRANSITION STAIR W/BARRI
12	370-0469	40" TRANSITION STAIR W/BARRI
13	370-0557	LINKING RING CLIMBER 80"-96"
14	370-0712	RUGGED RIDGE
15	370-0720	TRANSFER STATION, HANDRAIL
16	370-0806	TRIGON TOWER
17	370-0808	TWISTING TRAVERSE
18	370-0810	POWER PEAK W/ PANELS
19	370-0813	RIDGE POINT CLIMBER
20	370-0829	PLEXUS OVERHEAD
21	370-0830	PLEXUS HOLE CLIMBER
22	370-0833	PLEXUS STEP CLIMBER
23	370-0834	OVERHEAD POST ATTACHMENT
24	370-0851	VERTO CLIMBER 3 FS
25	370-0854	VERTO CLIMBER 1
26	370-0855	MERGE CLIMBER
27	370-1589	ROPE CLIMBER
28	370-1591	PODSTEP CLIMBER 48-56"
29	370-1593	PODSTEP LINK
30	470-0101	DYNAMIC PAD
31	470-0103	INTENSITY ROOF
32	470-0487	HALF HEX METAL ROOF
33	470-0544	VIPER R2 48-56
34	470-0596	VIPER III SPIRAL-SL3 112
35	470-0670	ARA SQUARE SHADE CANOPY
36	470-0738	VIPER R2 64-72 W/O HOOD
37	560-0190	ZIPVENTURE 75FT
38	560-0457	SWIFT TWIST SPINNER
39	560-0576	REV8
40	560-0683	ROPEVENTURE VERTEX
41	560-0684	ROPEVENTURE LINK
42	560-2571	COMET II
43	570-0394	PIPE WALL
44	580-0172	6' PVC TRADITIONAL BENCH W/IF

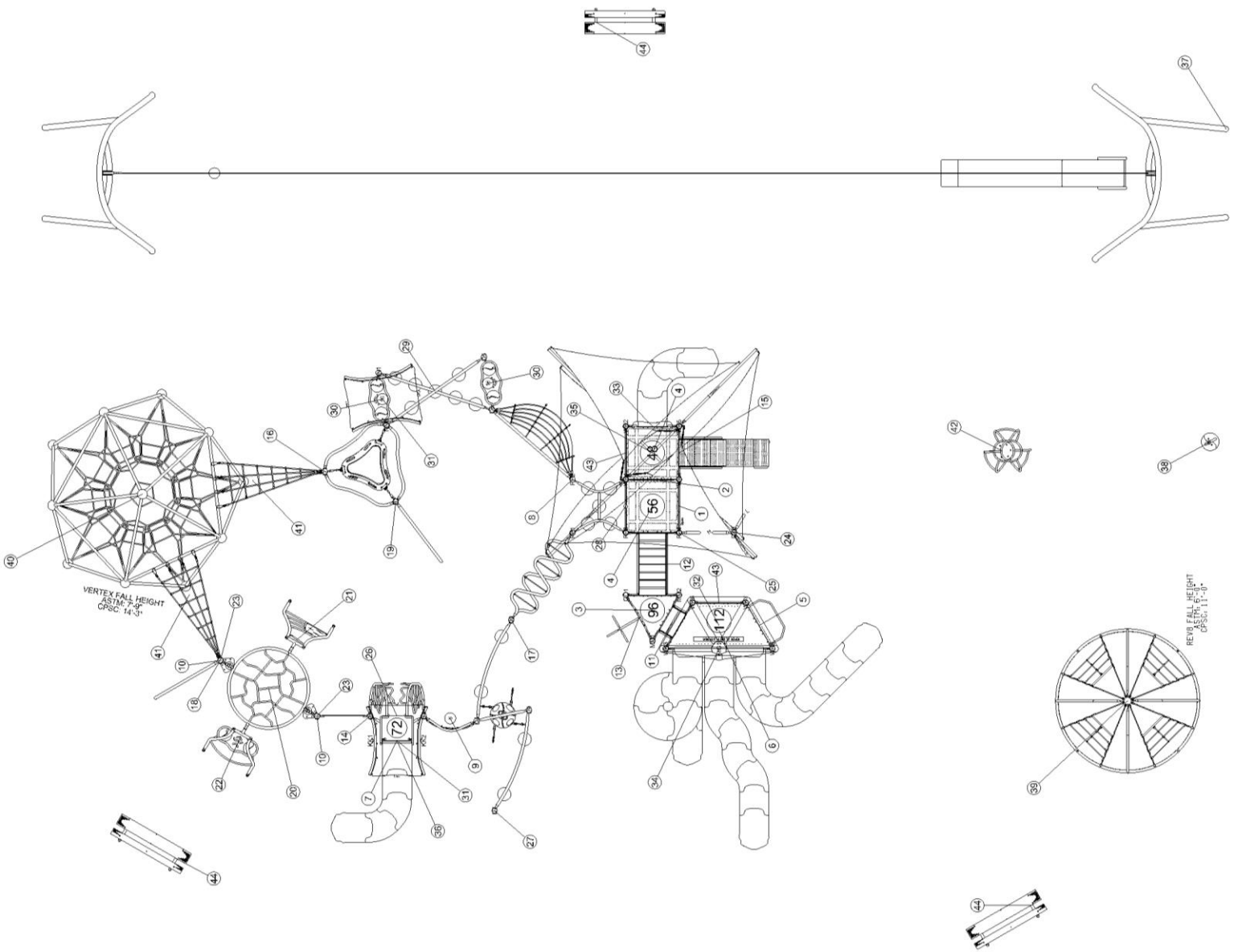

**Burke**

March 13, 2017

SERIES: Basics, Intensity, Nucleus  
 COMPONENT PLAN  
 DRAWN BY: Kari Champeau

Lexington Athletic Complex  
 4286 121st Ave. NE  
 Blaine, MN 55449

St. Croix Recreation Company, Inc.  
 100-99184-1



SERIES: Basics, Intensity, Nucleus  
 ELEVATION PLAN  
 DRAWN BY: Kari Champeau

Lexington Athletic Complex  
 4286 121st Ave. NE  
 Blaine, MN 55449

St. Croix Recreation Company, Inc.  
 100-99184-1

BCI Burke Company, LLC PO Box 549 Fond du Lac, Wisconsin 54936-0549 Telephone 920-921-9220

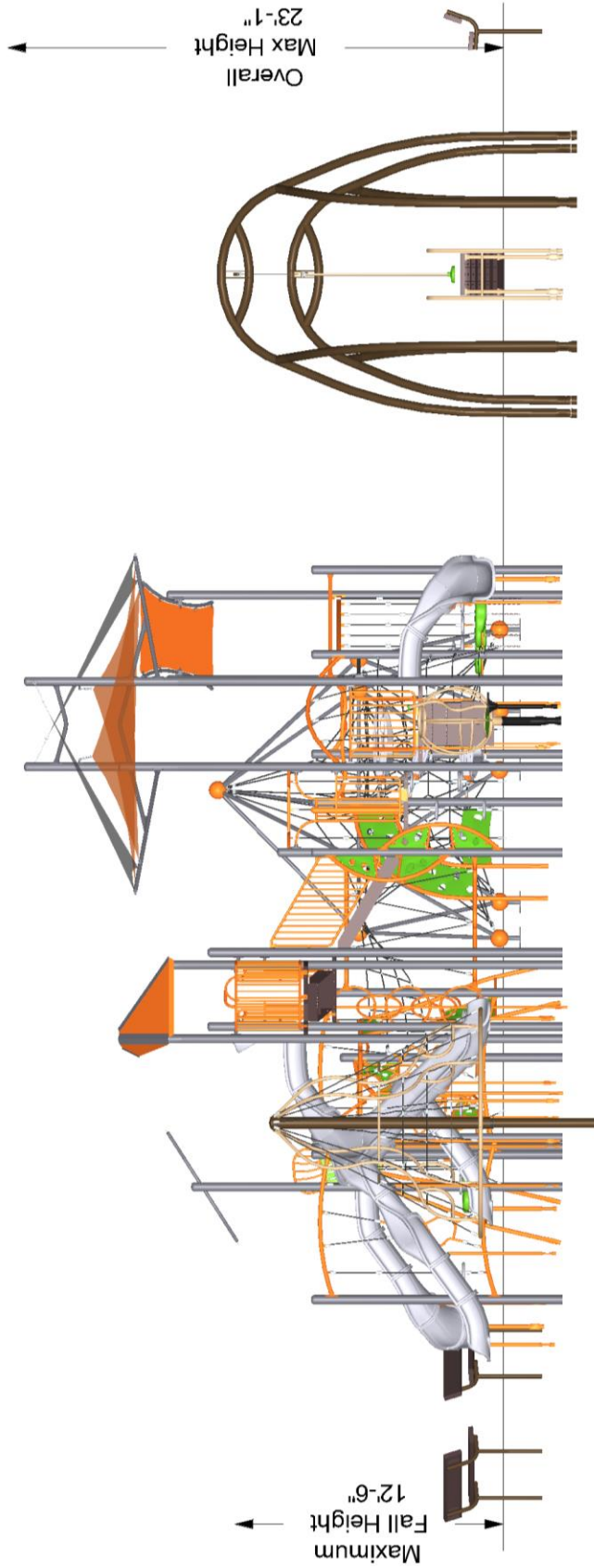

Rev8 Fall Height:  
 ASTM 6' 0"  
 CPSC 11' 0"  
 Vertex Fall Height:  
 ASTM 7' 9"  
 CPSC 14' 3"

The protective surfacing for this design must accommodate the critical fall height.

March 13, 2017

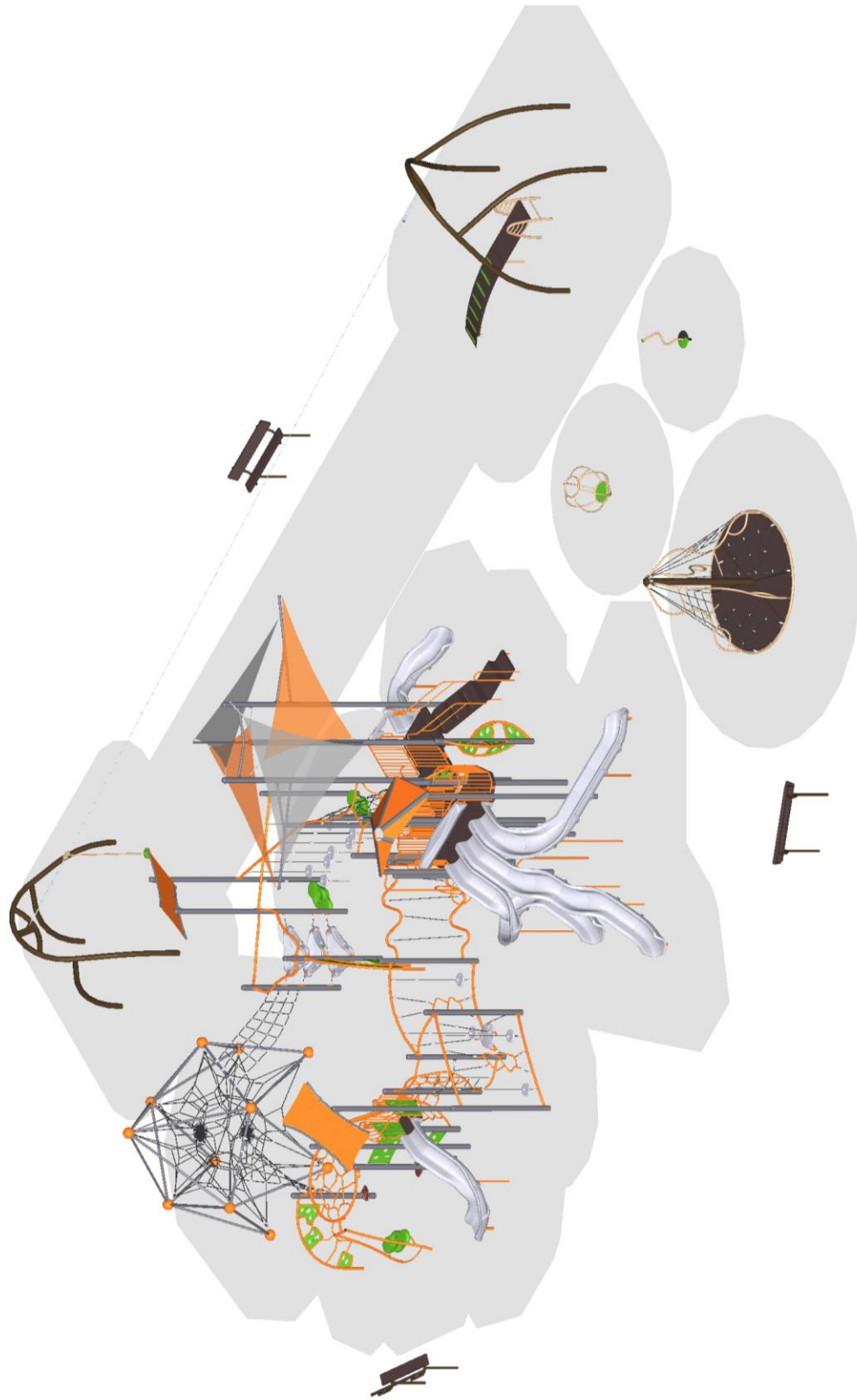

**Burke**

March 13, 2017

SERIES: Basics, Intensity, Nucleus

Lexington Athletic Complex

St. Croix Recreation Company, Inc.

ISOMETRIC PLAN

4286 121st Ave. NE

100-99184-1

DRAWN BY: Kari Champeau

Blaine, MN 55449

BCI Burke Company, LLC PO Box 549 Fond du Lac, Wisconsin 54936-0549 Telephone 920-921-9220



# 100-99184-1

March 13, 2017  
2017 Pricing

**Proposal Prepared for:**

Jerome Krieger, Recreation Manager  
City of Blaine Parks and Recreation Dept.  
10801 Town Square Drive  
Blaine, MN 55449  
Phone: 763-785-6161

**Project Location:**

Lexington Athletic Complex  
4286 121st Ave. NE  
Blaine, MN 55449

**Proposal Prepared by:**

St. Croix Recreation Company, Inc.  
225 N. Second Street  
Stillwater, MN 55082  
Phone: 651-430-1247  
Fax: 651-430-9231

Mike Basich  
Phone: 651-430-1247  
Cell: 612-369-6950  
mb@stcroixrec.com

Component No.	Description	Qty	Weight	Ext. Weight	Price	Ext. Price
<b>Burke Basics</b>						
550-0190	ZIPVENTURE 75FT	1	1,374	1,374	\$12,600	\$12,600
560-0457	SWIFT TWIST SPINNER	1	52	52	\$1,054	\$1,054
560-0576	REV8	1	1,343	1,343	\$16,115	\$16,115
560-0583	ROPEVENTURE VERTEX	1	1,340	1,340	\$15,000	\$15,000
560-0584	ROPEVENTURE LINK	2	38	76	\$2,000	\$4,000
560-2571	COMET II	1	149	149	\$1,632	\$1,632
580-0172	6' PVC TRADITIONAL BENCH W/BA...	3	119	357	\$487	\$1,461
List Price: \$51,862						
<b>Intensity</b>						
270-0287	SLIDE PLATFORM	1	152	152	\$2,079	\$2,079
370-0008	WILD WEB ROPE CLIMBER	1	77	77	\$3,900	\$3,900
370-0026	LIMBER LADDER ROPE CLIMBER	1	33	33	\$2,156	\$2,156
370-0027	LAUNCH PAD	2	9	18	\$225	\$450
370-0712	RUGGED RIDGE	1	34	34	\$541	\$541
370-0808	TWISTING TRAVERSE	1	103	103	\$1,562	\$1,562
370-0829	PLEXUS OVERHEAD	1	96	96	\$1,946	\$1,946
370-0830	PLEXUS HOLE CLIMBER	1	97	97	\$1,405	\$1,405
370-0833	PLEXUS STEP CLIMBER	1	121	121	\$1,297	\$1,297
370-0834	OVERHEAD POST ATTACHMENT	2	3	6	\$151	\$302
370-1589	ROPE CLIMBER	1	265	265	\$6,499	\$6,499
470-0101	DYNAMIC PAD	2	27	54	\$530	\$1,060
470-0103	INTENSITY ROOF	2	87	174	\$1,308	\$2,616
670-0097	INTENSITY CURRICULUM KIT	1	2	2	\$0	\$0
List Price: \$25,813						
<b>Nucleus</b>						
270-0001	OFFSET ENCLOSURE	1	30	30	\$320	\$320
270-0050	8" CLOSURE PLATE	1	10	10	\$110	\$110
270-0129	TRIANGLE PLATFORM	1	48	48	\$540	\$540
270-0130	SQUARE PLATFORM	2	106	212	\$965	\$1,930
270-0148	BALCONY	1	99	99	\$899	\$899
270-0236	VIPER SLIDE HALF HEX PLATFORM	1	145	145	\$1,236	\$1,236
370-0466	16" TRANSITION STAIR W/BARRIE...	1	109	109	\$1,465	\$1,465
370-0469	40" TRANSITION STAIR W/BARRIE...	1	279	279	\$2,594	\$2,594



# 100-99184-1

March 13, 2017

2017 Pricing

370-0557	LINKING RING CLIMBER 80"-96"	1	100	100	\$1,168	\$1,168
370-0720	TRANSFER STATION, HANDRAIL 48"	1	236	236	\$2,128	\$2,128
370-0806	TRIGON TOWER	1	172	172	\$5,948	\$5,948
370-0810	POWER PEAK W/ PANELS	1	87	87	\$1,045	\$1,045
370-0813	RIDGE POINT CLIMBER	1	162	162	\$1,372	\$1,372
370-0851	VERTO CLIMBER 3 FS	1	103	103	\$1,871	\$1,871
370-0854	VERTO CLIMBER 1	1	35	35	\$623	\$623
370-0855	MERGE CLIMBER	1	93	93	\$1,351	\$1,351
370-1591	PODSTEP CLIMBER 48-56"	1	90	90	\$4,295	\$4,295
370-1593	PODSTEP LINK	1	141	141	\$3,595	\$3,595
470-0487	HALF HEX METAL ROOF	1	181	181	\$1,686	\$1,686
470-0544	VIPER R2 48-56	1	154	154	\$2,268	\$2,268
470-0596	VIPER III SPIRAL-S-L3 112	1	801	801	\$9,328	\$9,328
470-0670	ARA SQUARE SHADE CANOPY	1	383	383	\$5,823	\$5,823
470-0738	VIPER R2 64-72 W/O HOOD	1	152	152	\$2,170	\$2,170
570-0394	PIPE WALL	2	36	72	\$583	\$1,166
600-0104	NPPS SUPERVISION SAFETY KIT	1	3	3	\$0	\$0
670-0098	MODULAR HARDWARE, NUCLEUS	1	5	5	\$0	\$0
670-0099	INSTALLATION KIT, INTENSITY	1	2	2	\$0	\$0
670-0103	MAINTENANCE KIT, INTENSITY	1	0	0	\$0	\$0
670-0149	POST ASSEMBLY 5" OD X 197"	2	104	208	\$475	\$950
670-0152	POST ASSEMBLY 5" OD X 220"	2	116	232	\$532	\$1,064
670-0159	POST ASSEMBLY 5" OD X 206"	2	109	218	\$518	\$1,036
670-0163	POST, SWAGED ROOF 5" OD X 220"	8	115	920	\$505	\$4,040
670-0165	POST ASSEMBLY 5" OD X 123"	3	66	198	\$315	\$945
670-0166	POST ASSEMBLY 5" OD X 139"	10	74	740	\$335	\$3,350
670-0168	POST ASSEMBLY 5" OD X 158"	4	84	336	\$388	\$1,552
670-0169	POST ASSEMBLY 5" OD X 171"	1	91	91	\$439	\$439
670-0403	VIPER III STUBBY POST 112	1	77	77	\$475	\$475

List Price: \$68,782

Total User Capacity:	210
Total Weight:	12,847 lbs.
Total Price:	\$146,457
<b>DISCOUNT:</b>	<b>-\$ 35,811</b>
332 L.F. Curb:	\$ 7,414
Engineered Wood Fiber:	\$ 8,840
Freight:	\$ 1,600
Installation:	<u>\$ 20,000</u>
<b>TOTAL BID PRICE:</b>	<b>\$150,000</b>

Information is relative to theMar 13 2017 4:35AM database.

Pricing is valid for 45 days from the date of this proposal. Burke reserves the right to make drawing and pricing adjustments based on latest safety requirements imposed by ADA, CPSC and ASTM.

If you have any questions, please call us.  
Thank you.



100-99184-1

March 13, 2017

2017 Pricing

***Selected Color List***

<b>Color Group</b>	<b>Color</b>
<i>Phase 1</i>	
Accessory	Orange
Post	Charcoal
Platform	Brown
Rotomolded	Granite
Kore Konnect	Charcoal
1 Color Extruded/Flat	Lime
Intensity/Rocky Mountain	Lime
Accessory	Orange
2 Color Extruded/Flat (outer)	Brown
2 Color Extruded/Flat (inner)	Tan
<i>Phase 2</i>	
Accessory	Tan
Platform	Brown
Post	Brown
1 Color Extruded/Flat	Lime
Rotomolded	Lime
Table/Bench Legs	Brown
Table/Bench	Brown

The colors listed above reflect the main colors selected. This proposal may contain individual colors that have overridden the main colors. These overridden colors are *not* contained in this list.