

Case File No. 14-0056

Blaine Planning Department / 10801 Town Square Dr NE / Blaine, MN 55449 / (763) 785-6180

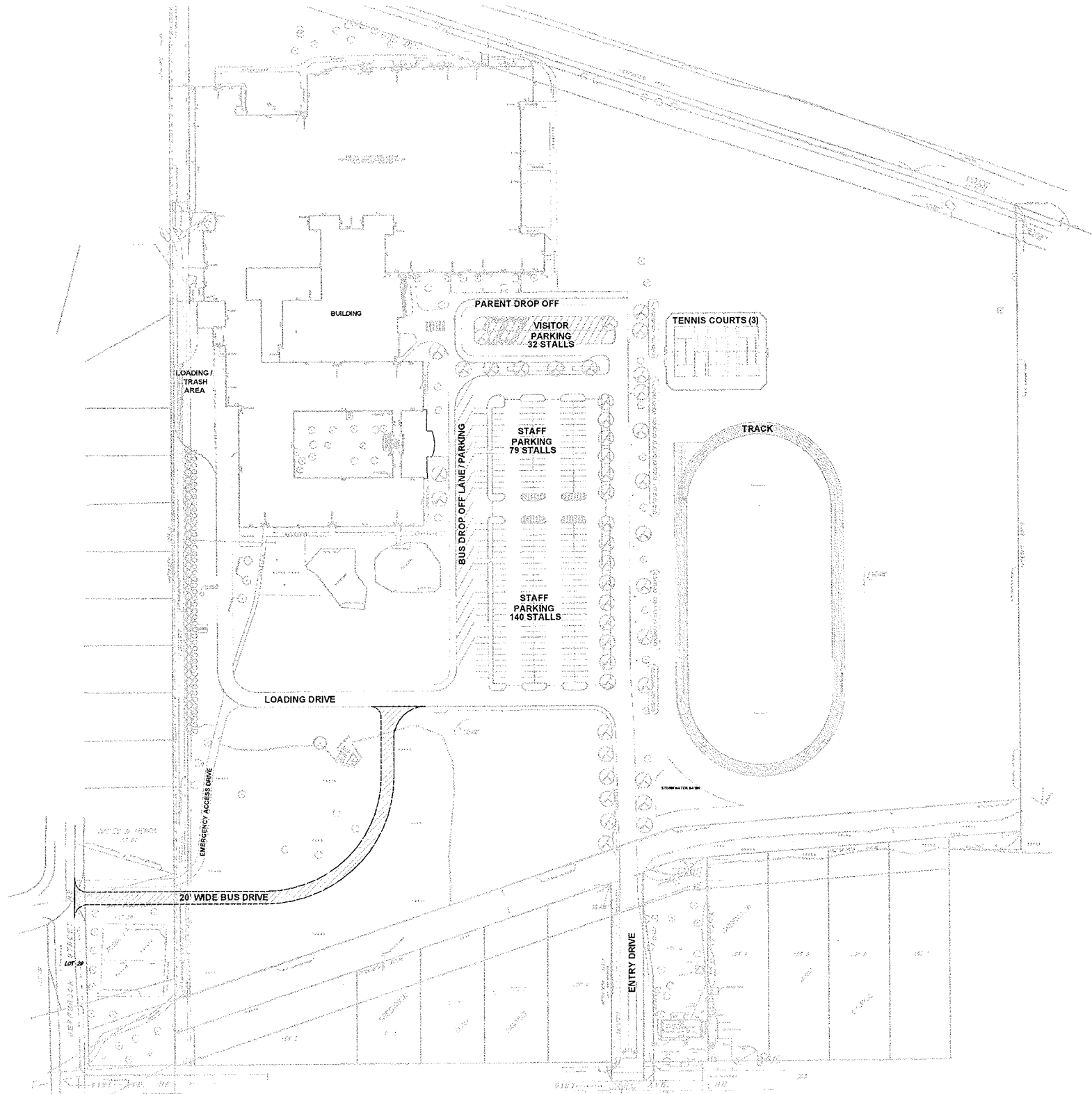



BUILDING

PARENT DROP OFF

VISITOR PARKING
32 STALLS

TENNIS COURTS (3)

LOADING/TRASH AREA

BUS DROP OFF LANE/PARKING

STAFF PARKING
79 STALLS

TRACK

STAFF PARKING
140 STALLS

LOADING DRIVE

EMERGENCY ACCESS DRIVE

20' WIDE BUS DRIVE

ENTRY DRIVE

EXHIBIT B

CUP – City of Blaine

Reason for request:

Westwood Intermediate School (grades 4-5) and Westwood Middle School (grades 6-8) share a common campus in Blaine. At this time, there are 1,875 students on this campus (approximately 375 per grade). Enrollment projections indicate that our student population will grow to over 2,300 (approximately 460 per grade) by the fall of 2018, with continued growth for a few years beyond that.

There is currently one entrance for all traffic into Westwood. With the number of buses, cars and student walkers that are entering and leaving our schools through this one driveway it causes congestion and increases the likelihood of accidents. The buses for our middle school at the end of the day currently wrap around and block some traffic trying to leave the campus.

We have staggered start times for our two schools on this campus which helps alleviate the number of buses and cars that drop off and pick up students at the same time. However, with the increase in future enrollment, the number of buses and cars will also continue to increase. For the 2014-15 school year we have the following traffic patterns:

	<u>Westwood Intermediate</u>		<u>Westwood Middle</u>	
	<u>Buses</u>	<u>Cars</u>	<u>Buses</u>	<u>Cars</u>
Morning drop off	25	50-75	30	50-75
Afternoon pick up	23	50-75	33	50-75

A second entrance would allow the school district to have a separate access for bus and car traffic for the morning and afternoon times that buses would be arriving and leaving. Separating the bus and car traffic increases student, staff and parent safety. The new entrance would be available to cars for evening activities.

Also added along the new driveway would be a sidewalk. This will allow student walkers coming from the west to avoid walking on 91st Avenue with heavy traffic and no sidewalks.