



14601 Ramsey Boulevard  
Ramsey, Minnesota 55303  
763-323-2600  
Fax: 763-506-9541  
1-800-642-1672  
www.connexusenergy.com  
info@connexusenergy.com

Mr. Jerome Krieger  
City of Blaine  
10801 Town Square Drive NE  
Blaine MN 55449

January 21, 2014

Dear Mr. Krieger,

I have prepared the following proposal to install outdoor lighting at the Lexington Athletic Complex as show on the attached sketch. Connexus Energy will install, retain ownership, and will provide ongoing maintenance of the lights under our monthly energy and maintenance rate. The installation cost shown below is a preliminary estimate prior to the final design by Connexus Energy's engineering department.

**Light Fixtures**

9 – Single 135 Watt LED Commercial area lights

9 – Double 135 Watt LED Commercial area lights

The light fixtures listed above will be mounted on 30' fiberglass poles. Four poles located adjacent to parking spaces will be mounted on 30" raised concrete bases.

8 – Decorative Cyclone Domia 60 W LED fixtures on 14' poles. The poles and fixtures are a textured dark green finish.

Total material, labor, electrical feed, and control cabinet. \$111,996.00

The monthly energy and maintenance rate for the 135 Watt lights will be \$9.46 per light per month, and \$7.96 per light, per month, for the 60 Watt lights, based on dusk to dawn operation. If time clock operation is preferred, the lights will be metered and a monthly maintenance only rate of \$2.25 per luminaire per month will apply to the LED lights.

The lights will be installed to utility specifications, and will be maintained by Connexus Energy. The above installation costs are based upon our best practices. If job site conditions beyond our control prevent normal installation procedures or if winter construction is required, additional charges may be applied. Although care will be taken to allow for minimal restoration, Connexus Energy will not be responsible for final restoration of groomed turf.

**Please indicate your acceptance of this proposal by returning a signed copy via, USPS, Fax 763-323-2711, or e-mail: leoo@connexusenergy.com**

I hope that this information is satisfactory for you. Do not hesitate to contact me if you have any questions.

Sincerely,

**Leo Offerman**

Key Account Representative

Digitally signed by Leo Offerman  
DN: cn=Leo Offerman, o=Connexus  
Energy, ou=CEM,  
email=leoo@connexusenergy.com, c=US  
Date: 2014.01.21 14:45:16 -06'00'

Accepted by: \_\_\_\_\_

Date: \_\_\_\_\_

# Lexington Athletic Complex

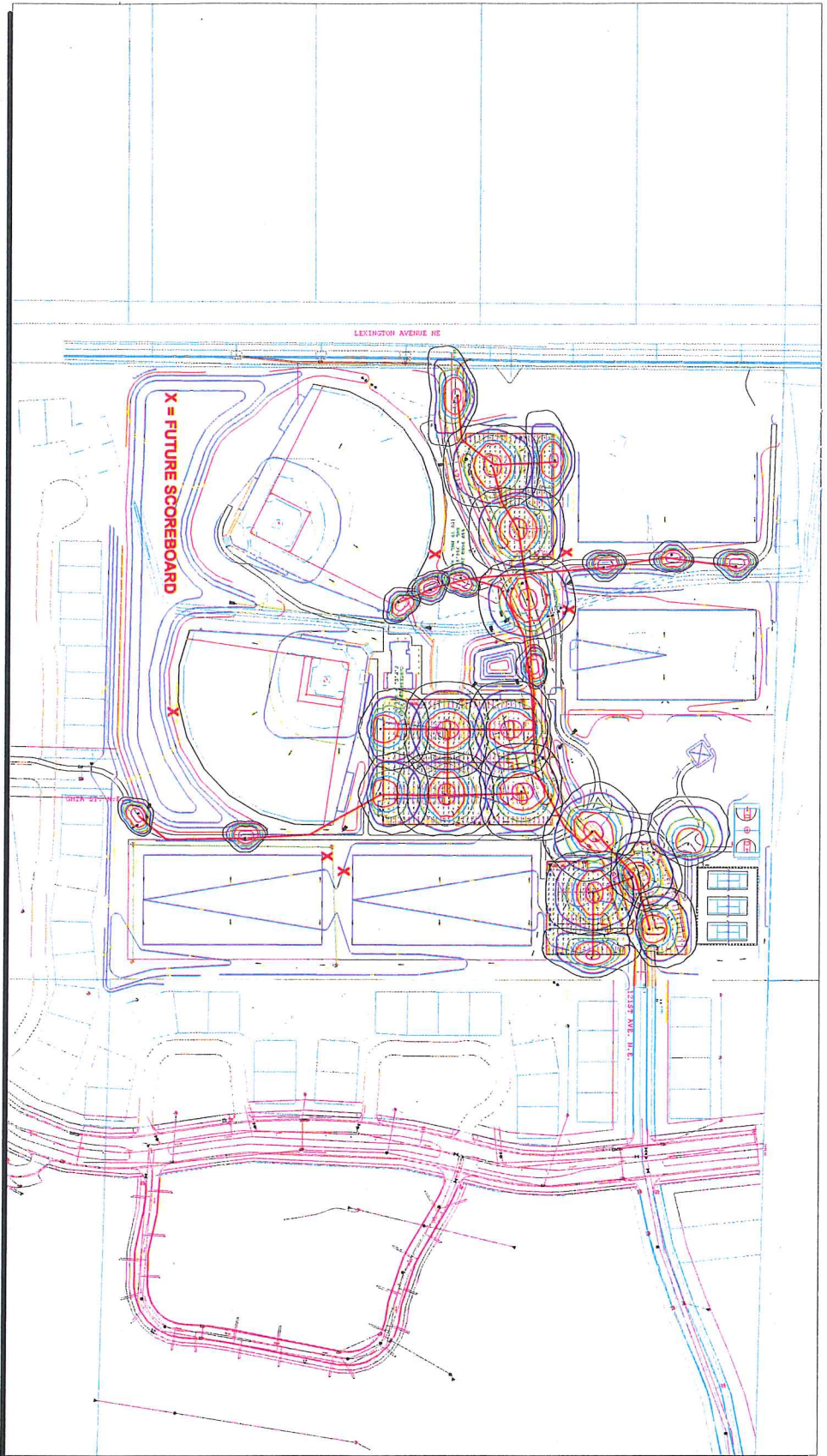

Calculation Summary						
Label	Units	Avg	Max	Min	Avg/Min	Max/Min
Central Lot	Fc	1.01	4.3	0.2	5.05	21.50
East Lots	Fc	0.81	4.8	0.1	8.10	48.00
West Lot	Fc	1.03	4.8	0.2	5.15	24.00

Luminaire Schedule			
Qty	Label	Description	
3	SG-L-RVS135W III	RVS-135W80LED4K-LE3	
5	SG-L-RVS135W IV	RVS-135W80LED4K-LE4	
9	DBL-RVS135W IV	RVS-135W80LED4K-LE4	
9	Domia 60W LED	DOMIA-CY55P1-GAL-3	

