

DEACON'S POND 3RD ADDITION

CITY OF BLAINE
 COUNTY OF ANOKA
 SEC. 9, TWP. 31, RNG. 23

KNOW ALL PERSONS BY THESE PRESENTS: That TJB Development Company, a Minnesota corporation, owner of the following described property:

Outlot A & B, DEACON'S POND 2ND ADDITION, Anoka County, Minnesota.

AND

Outlot C, DEACON'S POND, Anoka County, Minnesota.

Has caused the same to be surveyed and platted as DEACON'S POND 2ND ADDITION and does hereby dedicate to the public for public use the drainage and utility easements as shown on this plat.

In witness whereof said TJB Development Company, a Minnesota corporation, has caused these presents to be signed by its proper officer this _____ day of _____, 20____,
 TJB DEVELOPMENT COMPANY

 Thomas J. Budzynski, President

STATE OF MINNESOTA
 COUNTY OF _____

This instrument was acknowledged before me this _____ day of _____, 20____ by Thomas J. Budzynski, as President of TJB Development Company, a Minnesota corporation, on behalf of the corporation.

 Notary Public, _____, County, Minnesota
 My Commission Expires _____

I Joshua P. Schneider do hereby certify that this plat was prepared by me or under my direct supervision; that I am a duly Licensed Land Surveyor in the State of Minnesota; that this plat is a correct representation of the boundary survey; that all mathematical data and labels are correctly designated on this plat; that all monuments depicted on this plat have been, or will be correctly set within one year; that all water boundaries and wet lands, as defined in Minnesota Statutes, Section 505.01, Subd. 3, as of the date of this certificate are shown and labeled on this plat, and all public ways are shown and labeled on this plat.

Dated this _____ day of _____, 20____.

 Joshua P. Schneider, Licensed Land Surveyor
 Minnesota License Number 44655

STATE OF MINNESOTA
 COUNTY OF _____

This instrument was acknowledged before me this _____ day of _____, 20____ by Joshua P. Schneider.

 Notary Public, _____, County, Minnesota
 My Commission Expires _____

CITY COUNCIL, CITY OF BLAINE, MINNESOTA

This plat of DEACON'S POND 2ND ADDITION was approved and accepted by the City Council of the City of Blaine, Minnesota at a regular meeting thereof held this _____ day of _____, 20____, and said plat is in compliance with the provisions of Minnesota Statutes, Section, 505.03, Subd. 2.

CITY COUNCIL, CITY OF BLAINE, MINNESOTA

By: _____, Mayor

By: _____, Clerk

COUNTY SURVEYOR

I hereby certify that in accordance with Minnesota Statutes, Section 505.021, Subd. 11, this plat has been reviewed and approved this _____ day of _____, 20____.

By: _____
 Larry D. Hoium
 Anoka County Surveyor

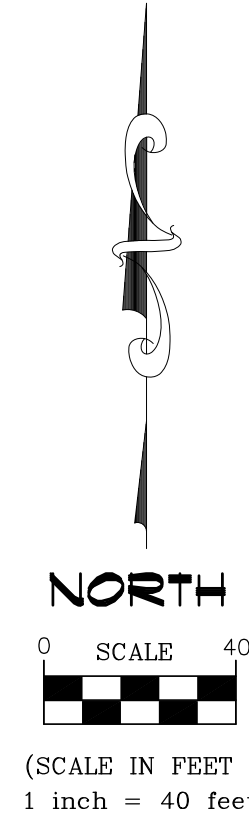

FOR THE PURPOSES OF THIS PLAT, THE NORTH LINE OF OUTLOT A, DEACON'S POND 2ND ADDITION, ANOKA COUNTY, MINNESOTA, IS ASSUMED TO BEAR N89°37'34"W.

DRAINAGE AND UTILITY EASEMENTS SHOWN THUS:

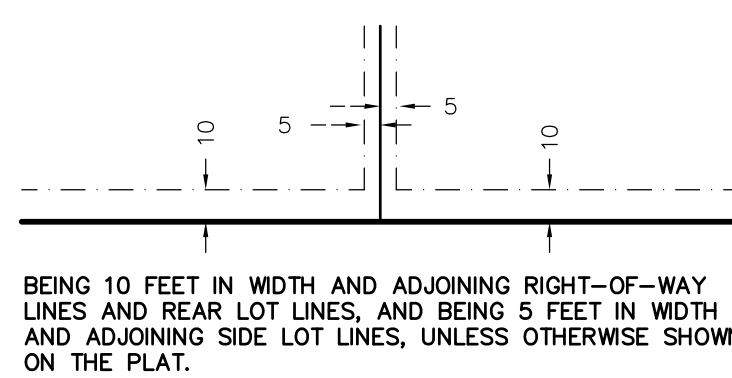

BEING 10 FEET IN WIDTH AND ADJOINING RIGHT-OF-WAY LINES AND REAR LOT LINES, AND BEING 5 FEET IN WIDTH AND ADJOINING SIDE LOT LINES, UNLESS OTHERWISE SHOWN ON THE PLAT.

